



# **Stainless Steel 4L Countertop DISTILLER MANUAL**

**Read Before Operating**

## SAFETY INSTRUCTIONS - SCALDING DANGER!

- Do not allow children or anyone needing care or supervision to use this appliance alone
- Never remove the top of the distiller when it is on or for at least 30 minutes after it has turned off. Always allow the unit to cool before removing the top of the unit to avoid potential hot water or steam injury.
- Do not allow any cord to hang over the counter which could get tangled or caught resulting in the unit being pulled off of the countertop.
- Always operate the unit on a dry, flat, heat-tolerant surface, out of the reach of children.

## ELECTRICAL PRECAUTIONS: DON'T PLUG IT IN WRONG!

- **This appliance must not be used on a double plug socket or extension - please be aware that if the Distiller receives low voltage it will blow the fuse. This means that if you have too many high-voltage appliances running at the same time, for example a toaster, a kettle, a distiller, and a washing machine all on the same kitchen circuit, this will cause damage to the appliance and invalidate your warranty. Ensure when using this appliance, you use it on a single socket into a wall.**
- To avoid the risk of arching or shorting, when connecting the Fan and Main Power Cords, always plug in the Main Power Cord to the wall outlet LAST. When disconnecting the Fan and Main Power Cords, always unplug the Main Power Cord from the wall outlet FIRST.
- Push plugs firmly all the way into the sockets to avoid a poor connection that could result in arching.
- Do not share the same outlet with other high-wattage appliances while operating in order to prevent overloading.
- Always unplug the Main Power Cord before filling or cleaning the unit or whenever not in use. Do not use extension cords unless absolutely necessary. However, use of a power strip to protect against lightning strikes and power surges is acceptable.
- Never immerse any part of the unit in water, (except Carafe), and keep the outside of the unit and plug sockets dry.

- The unit turns off automatically upon completion. Only if you must stop the process early, unplug the Main Power Cord from the wall outlet.
- Do not attempt to make any repairs to the unit. It should be repaired only by an Osmio-certified repairer.

**Before use:**

**Read these user instructions carefully before starting to use the equipment.**

**Recommendations:**

- Always place the equipment on a level surface and make sure there is adequate ventilation
- Remove the plug from the power socket when the equipment is not in use – this also applies when filling, emptying and cleaning
- Never use an electric cable that is damaged
- Ensure to plug the system into a single socket
- Do not immerse either of the equipment components in water and ensure that the exterior remains dry
- When distilling has been completed, it is recommended to only disconnect the power cables and remove the casing lid after it has cooled for at least 10 minutes. This is to prevent burning caused by the steam
- Never allow children to operate the equipment
- Do not clean the equipment using steel brushes or abrasives
- Never pour boiling water into the glass bottle

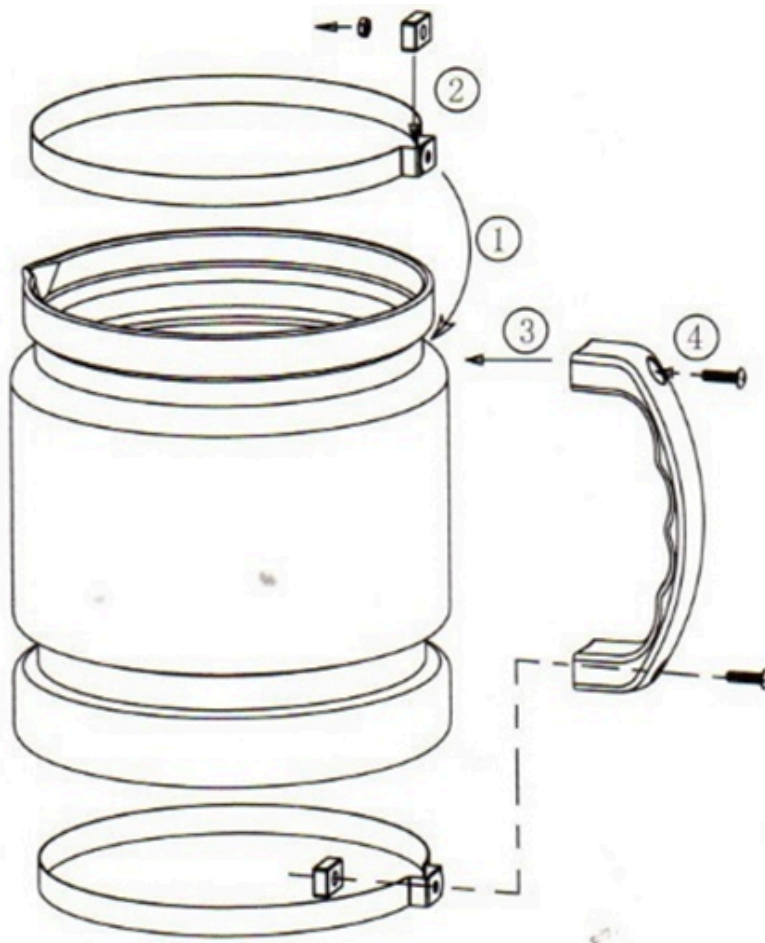

### **Glass Bottle Assembly Method**

1. Put the stainless steel belt into the slot of the glass bottle
2. Insert the moveable block into the stainless steel belt groove. Note: The nut on the moveable block faces the glass bottle
3. Fit the concave part of the stainless steel belt
4. Tighten the screws



The equipment consists of two main components:

- 1) Lower watertray and barrel body (where you fill up the water)
- 2) Head assembly lid with the cooling spiral/cooling fan (this goes ontop after you filled up the water)



#### **Stainless steel water tray**

304 stainless steel waterplate, stainless steel baffle, water contact parts are 304 stainless steel material.



#### **Stainless steel barrel body**

304 stainless steel, the inner wall is smooth and brushed, and the water level scale is printed.

Pour tap water into the stainless steel casing up to the maximum level line (4 litres). The distilling process is quicker when using hot water



#### The nose components

Head assembly handle, easy to handle.



#### Stainless steel spout

304 stainless steel nozzle, surface fine polishing, clean and beautiful.

Put the lid back on the casing and plug the power cable from the lid into the matching socket on the casing. Make sure that the lid is properly fitted to the casing and ensure the plug is fully connected



Place the glass container under the outlet of the equipment to collect the distilled water

 <div data-bbox="722 325 1018 623">  <p>With temperature display screen and temperature control button, you can adjust the temperature at will.</p> </div> <div data-bbox="722 674 1018 972">  <p>Automatic power-off protection function</p> </div>	<p>Now connect the power cable into the casing and plug it into a suitable power socket (single power socket)</p>
	<p>Set the desired temperature for distilling, a maximum of 108°C, by pressing the Up Arrow until you see the desired temperature displayed. Then press the Red Reset (on/off) button. The cooling fan starts rotating and it starts to warm up</p> <ul style="list-style-type: none"> <li>• The first drops of distilled water appear in the glass bottle after approximately 30 minutes</li> </ul>

Remove the cable from the power socket once all the water has been distilled. If this is not done, the equipment automatically switches off the heating element after a period of time

If you want to continue distilling, it is recommended to only disconnect the power cables and remove the lid from the casing after about 10 minutes. This is to prevent burning caused by steam. Next, pour water into the casing and start the whole process over again.

It is recommended not to use the first glass bottle of distilled water from the equipment. This may be contaminated by the manufacturing process or the packaging.

To distill water, we recommend setting the device to the maximum temperature of 108°C. For other applications, it is better to use the standard temperature of 95°C.

When the equipment reaches the target temperature, the cooling fan will gap rotation, this means that it is keeping the set temperature

If the water has a taste at the beginning of use, it is normal, use citric acid cleaning agent and hot water for 12 hours, after using 7-8 times it will be normal.

**Warning: the device can become hot during use...**



### **Cleaning:**

- Use a normal cleaning detergent for cleaning the exterior of the equipment. Apply it by using a damp cloth and then dry it off
- Use tap water for rinsing the internal parts of the stainless steel casing. This must be done each time after use. If necessary, add a little Citric Acid to the water in order to remove any deposits.
- Never submerge the unit in water. (Try to keep the outside of the unit dry while cleaning.) If scale remains, pour in approx. one-half cup of plain white distilled vinegar and let set for an hour or so as needed and then loosen with a sponge, (or Scotch-Brite™, etc.), and rinse out. Difficult residue may require periodic use of a safe water scale cleaner.

### **System Error Messages:**

**E** If for any reason the temperature becomes too high, the thermal device will automatically switch off the heating element. “E” appears on the display. After cooling down, remove the equipment cable from the power socket. The equipment works normally again when the cable is plugged back into the power socket.

**H** “H” is displayed and the equipment stops working when the preset temperature is exceeded. Press the Reset button to continue distilling

**F** This message indicates that the temperature sensor is defective

### **Warranty:**

24 months total from the order date. If the unit malfunctions within this time it will be repaired or replaced. Damage caused by improper handling, installation, or maintenance, low voltage, or use of voltage adapters, converters, or transformers or customer misuse or fuse replacement due to the customer's faulty or incorrect electrical wiring is not covered.

## **CE - Declaration of Conformity**



**Document number:** DOC-2022-I10002099

**Manufacturer or representative:** Osmio Solutions LTD

**Address:** Eternal Lake Reserve,  
Salt Lane, Cliffe ME3 7RT

**Brand name or trademark:** OSMIO

**Product type/Description:** Stainless steel Alcohol distiller with LCD screen

**Product Model:** OS/YMK40203

**Product SKU/ EAN:** I10002099/ 5060386327004

**Rated Voltage:** 220-240V~  
**Rated Frequency:** 50-60Hz  
**Rated Power:** 750W  
**Protection class:** I

**Tested according to:** EN 55014-1:2017/A11:2020  
EN 55014-2:2015  
EN IEC 61000-3-2:2019  
EN 61000-3-3:2013/A1:2019

This Declaration of Conformity is issued on a voluntary basis according to the Directive 2014/30/EU relating to electromagnetic compatibility. It confirms that the listed apparatus complies with all essential requirements of the directive and is based on the technical specifications applicable at the time of issuance. It refers only to the particular sample submitted for testing and certification. CE marking can be affixed on the product. That Declaration of conformity is issued under the sole responsibility of the manufacturer. Other relevant EU-directives have to be observed.  
[www.tuvsud.com/ps-cert](http://www.tuvsud.com/ps-cert)

**Test report no:** 4840121209201  
**Test date** Date, 2021-08-19

**Signed:** Irina Kent

A handwritten signature in black ink, appearing to read "Irina Kent", written over a faint horizontal line.

**Position:** Operations Director  
**Place:** United Kingdom

This product may not be treated as household waste. Instead it shall be handed over to the applicable collection point for the recycling of electrical and electronic equipment. By ensuring this product is disposed of correctly, you will help prevent potential negative consequences for the environment and human health, which could otherwise be caused by inappropriate waste handling of this product.